

Production Worksheet

Wilcom EmbroideryStudio - Designing

LABOUR DAY A 5X5

Design: **Labour Day A 5x5**



Title:

Stitches: 8,488
 Height: 105.2 mm
 Width: 127.2 mm
 Colors: 3
 Colorway: Colorway 1
 Zoom: 0.94

z digitizing
 support@zdigitizing.com
 +1 (213) 788-6748

Machine format: Tajima
 Color changes: 2
 Stops: 3
 Trims: 37
 Left: 63.7 mm
 Right: 63.6 mm
 Up: 52.6 mm
 Down: 52.6 mm
 EndX: 0.0 mm
 EndY: 0.0 mm
 Area: 13384.9 mm²
 Max stitch: 6.7 mm
 Min stitch: 0.2 mm
 Max jump: 6.7 mm

Stop Sequence:

#	N#	Color	St.	Code	Name	Chart
1.	3		3,662	1481		Madeira Classic 40
2.	2		7,387	1366	Sailor Blue	Madeira Classic 40
3.	1		8,486	1003	Cream White	Madeira Classic 40



Color Film

Wilcom EmbroideryStudio - Designing

LABOUR DAY A 5X5

Design: **Labour Day A 5x5**

Title:

Stitches: 8,488
Height: 105.2 mm
Width: 127.2 mm
Colors: 3
Colorway: Colorway 1
Zoom: 0.37



support@zdigitizing.com
+1 (213) 788-6748

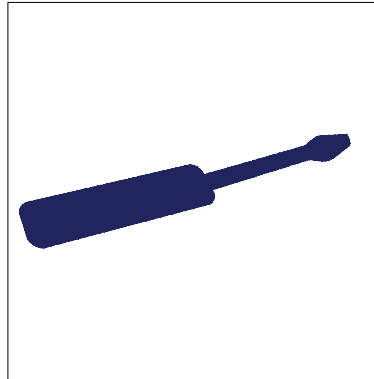

Stop #: 1
Element:
Code: 1481
Name:
Chart: Madeira Classic 40
Stitches: 3,662
Thread used: 21.60m

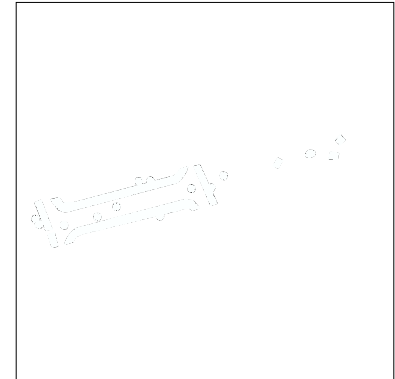

Stop #: 2
Element:
Code: 1366
Name: Sailor Blue
Chart: Madeira Classic 40
Stitches: 3,725
Thread used: 21.84m



Stop #: 3
Element:
Code: 1003
Name: Cream White
Chart: Madeira Classic 40
Stitches: 1,099
Thread used: 5.57m