

# Production Worksheet

Wilcom EmbroideryStudio - Designing

## \*ROKAT 4X4\*

Design: **Rokat 4x4**

Title:

Stitches: 16,120  
Height: 70.4 mm  
Width: 95.3 mm  
Colors: 9  
Colorway: Colorway 1  
Zoom: 1.19

**z digitizing**  
support@zdigitizing.com  
+1 (213) 788-6748

Machine format: Tajima  
Color changes: 12  
Stops: 13  
Trims: 23  
Left: 47.7 mm  
Right: 47.7 mm  
Up: 35.2 mm  
Down: 35.2 mm  
EndX: 0.0 mm  
EndY: 0.0 mm  
Area: 6713.1 mm<sup>2</sup>  
Max stitch: 8.4 mm  
Min stitch: 0.0 mm  
Max jump: 6.9 mm

### Stop Sequence:

#	N#	Color	St.	Code	Name	Chart
1.	1	█	4,347	1243	Pea Coat	Madeira Classic 40
2.	3	█	6,138	1095	Larimar	Madeira Classic 40
3.	4	█	8,686	1010	Gray Haze	Madeira Classic 40
4.	6	█	8,933	1147	Christmas Red	Madeira Classic 40
5.	5	█	9,506	1415		Madeira Classic 40
6.	2	█	10,163	1171	Lemon Drop	Madeira Classic 40
7.	6	█	11,403	1147	Christmas Red	Madeira Classic 40
8.	3	█	12,369	1095	Larimar	Madeira Classic 40
9.	4	█	12,649	1010	Gray Haze	Madeira Classic 40
10.	7	█	12,876	1000	Black	Madeira Classic 40
11.	8	█	13,793	1001	White	Madeira Classic 40
12.	2	█	15,497	1171	Lemon Drop	Madeira Classic 40
13.	9	█	16,118	1278	Orange Peel	Madeira Classic 40

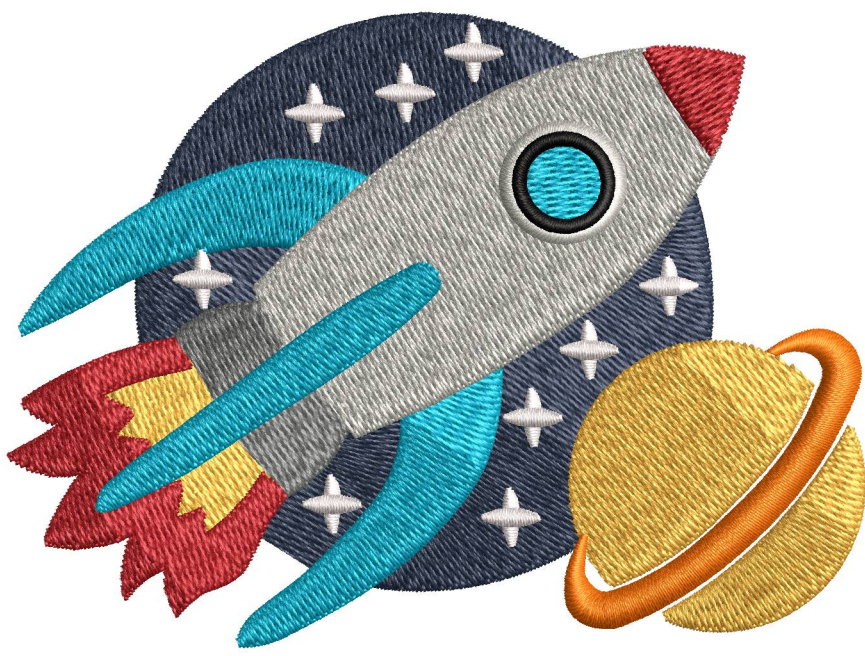

# Color Film

Wilcom EmbroideryStudio - Designing

## \*ROKAT 4X4\*

Design: **Rokat 4x4**

Title:

Stitches: 16,120  
Height: 70.4 mm  
Width: 95.3 mm  
Colors: 9  
Colorway: Colorway 1  
Zoom: 0.50

**z digitizing**  
support@zdigitizing.com  
+1 (213) 788-6748



Stop #: 1  
Element:  
Code: 1243  
Name: Pea Coat  
Chart: Madeira Classic 40  
Stitches: 4,347  
Thread used: 25.52m

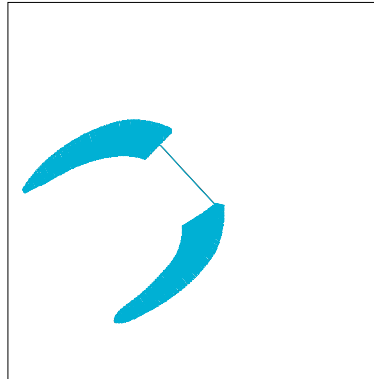

Stop #: 2  
Element:  
Code: 1095  
Name: Larimar  
Chart: Madeira Classic 40  
Stitches: 1,791  
Thread used: 9.39m

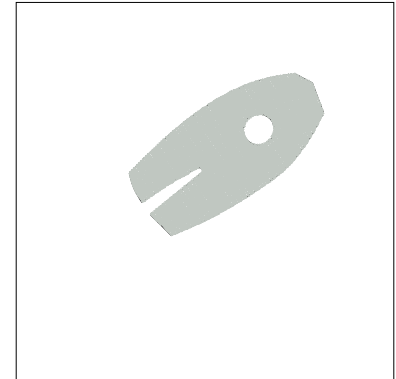

Stop #: 3  
Element:  
Code: 1010  
Name: Gray Haze  
Chart: Madeira Classic 40  
Stitches: 2,548  
Thread used: 15.78m

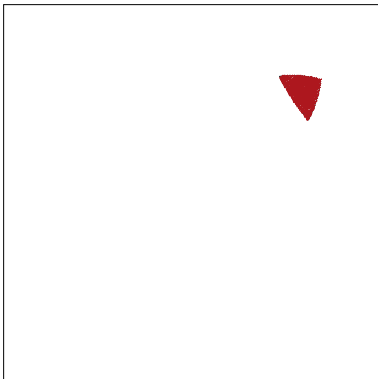

Stop #: 4  
Element:  
Code: 1147  
Name: Christmas Red  
Chart: Madeira Classic 40  
Stitches: 247  
Thread used: 1.24m

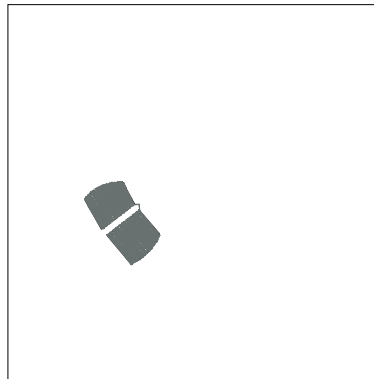

Stop #: 5  
Element:  
Code: 1415  
Name:  
Chart: Madeira Classic 40  
Stitches: 573  
Thread used: 3.19m

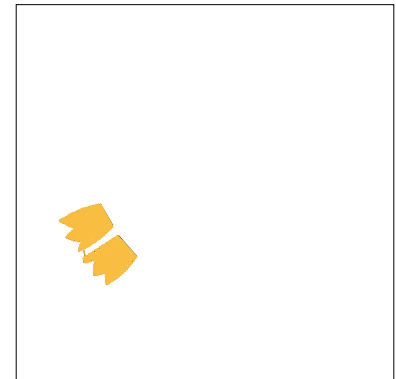

Stop #: 6  
Element:  
Code: 1171  
Name: Lemon Drop  
Chart: Madeira Classic 40  
Stitches: 657  
Thread used: 3.27m

# Color Film

Wilcom EmbroideryStudio - Designing

## \*ROKAT 4X4\*

Design: **Rokat 4x4**

Title:

Stitches: 16,120  
Height: 70.4 mm  
Width: 95.3 mm  
Colors: 9  
Colorway: Colorway 1  
Zoom: 0.50

**z digitizing**  
support@zdigitizing.com  
+1 (213) 788-6748

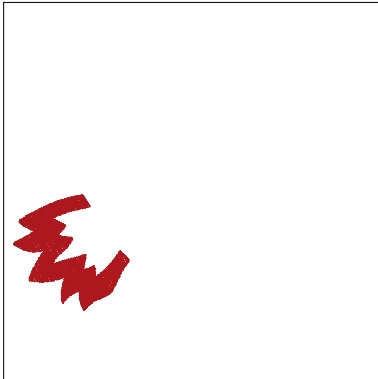

Stop #: 7  
Element:  
Code: 1147  
Name: Christmas Red  
Chart: Madeira Classic 40  
Stitches: 1,240  
Thread used: 6.15m

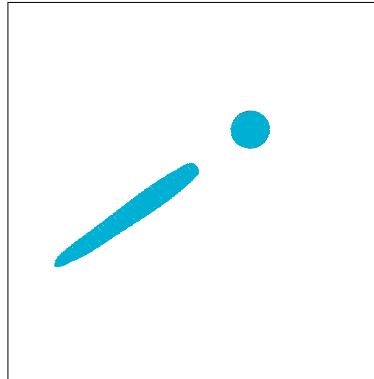

Stop #: 8  
Element:  
Code: 1095  
Name: Larimar  
Chart: Madeira Classic 40  
Stitches: 966  
Thread used: 4.80m

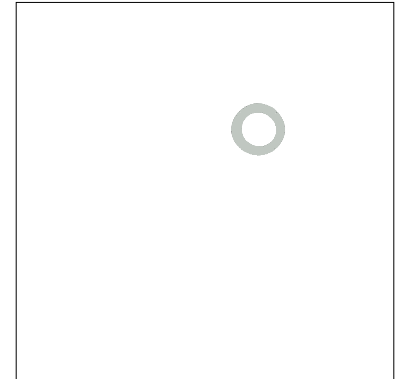

Stop #: 9  
Element:  
Code: 1010  
Name: Gray Haze  
Chart: Madeira Classic 40  
Stitches: 280  
Thread used: 1.44m

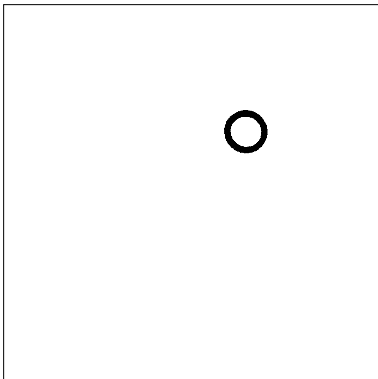

Stop #: 10  
Element:  
Code: 1000  
Name: Black  
Chart: Madeira Classic 40  
Stitches: 227  
Thread used: 0.93m

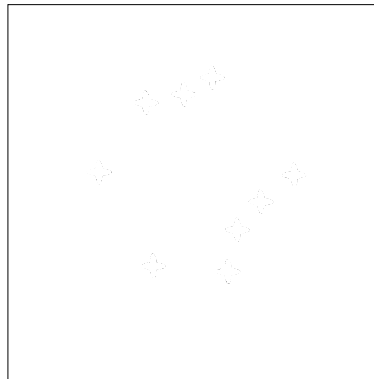

Stop #: 11  
Element:  
Code: 1001  
Name: White  
Chart: Madeira Classic 40  
Stitches: 917  
Thread used: 3.54m

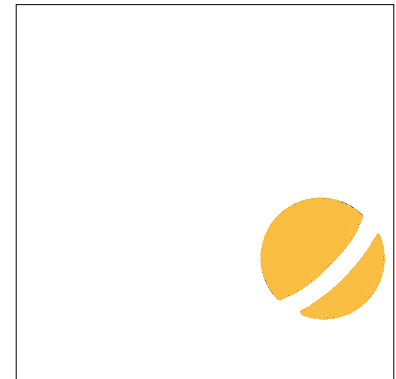

Stop #: 12  
Element:  
Code: 1171  
Name: Lemon Drop  
Chart: Madeira Classic 40  
Stitches: 1,704  
Thread used: 9.84m

**Color Film**

Wilcom EmbroideryStudio - Designing

**\*ROKAT 4X4\***

Design: **Rokat 4x4**

Title:

Stitches: 16,120  
Height: 70.4 mm  
Width: 95.3 mm  
Colors: 9  
Colorway: Colorway 1  
Zoom: 0.50

**z digitizing**  
support@zdigitizing.com  
**+1 (213) 788-6748**

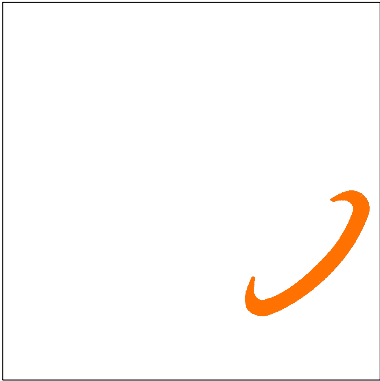

Stop #: 13  
Element:  
Code: 1278  
Name: Orange Peel  
Chart: Madeira Classic 40  
Stitches: 621  
Thread used: 4.05m