

Production Worksheet

Wilcom EmbroideryStudio - Designing

ROKAT 5X5

Design: **Rokat 5x5**

Title:

Stitches: 25,044
 Height: 93.9 mm
 Width: 127.2 mm
 Colors: 9
 Colorway: Colorway 1
 Zoom: 0.89

z digitizing
 support@zdigitizing.com
 +1 (213) 788-6748

Machine format: Tajima
 Color changes: 12
 Stops: 13
 Trims: 23
 Left: 63.6 mm
 Right: 63.6 mm
 Up: 47.0 mm
 Down: 47.0 mm
 EndX: 0.0 mm
 EndY: 0.0 mm
 Area: 11946.4 mm²
 Max stitch: 11.3 mm
 Min stitch: 0.1 mm
 Max jump: 6.7 mm

Stop Sequence:

| # | N# | Color | St. | Code | Name | Chart |
|-----|----|-------|--------|------|---------------|--------------------|
| 1. | 1 | | 7,053 | 1243 | Pea Coat | Madeira Classic 40 |
| 2. | 3 | | 9,856 | 1095 | Larimar | Madeira Classic 40 |
| 3. | 4 | | 14,063 | 1010 | Gray Haze | Madeira Classic 40 |
| 4. | 6 | | 14,439 | 1147 | Christmas Red | Madeira Classic 40 |
| 5. | 5 | | 15,344 | 1415 | | Madeira Classic 40 |
| 6. | 2 | | 16,313 | 1171 | Lemon Drop | Madeira Classic 40 |
| 7. | 6 | | 18,158 | 1147 | Christmas Red | Madeira Classic 40 |
| 8. | 3 | | 19,645 | 1095 | Larimar | Madeira Classic 40 |
| 9. | 4 | | 20,015 | 1010 | Gray Haze | Madeira Classic 40 |
| 10. | 7 | | 20,314 | 1000 | Black | Madeira Classic 40 |
| 11. | 8 | | 21,470 | 1001 | White | Madeira Classic 40 |
| 12. | 2 | | 24,224 | 1171 | Lemon Drop | Madeira Classic 40 |
| 13. | 9 | | 25,042 | 1278 | Orange Peel | Madeira Classic 40 |

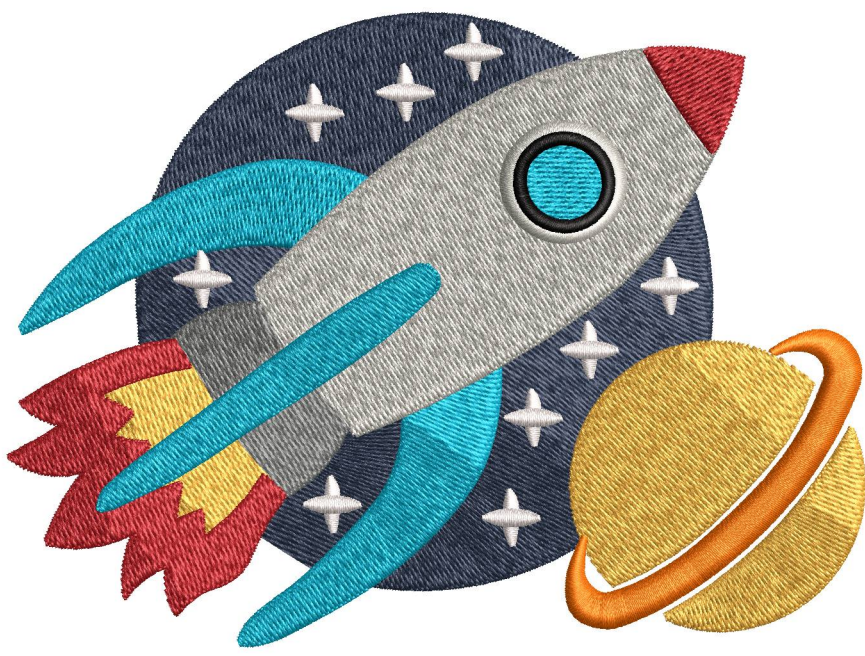

Color Film

Wilcom EmbroideryStudio - Designing

ROKAT 5X5

Design: **Rokat 5x5**

Title:

Stitches: 25,044
Height: 93.9 mm
Width: 127.2 mm
Colors: 9
Colorway: Colorway 1
Zoom: 0.37



support@zdigitizing.com
+1 (213) 788-6748

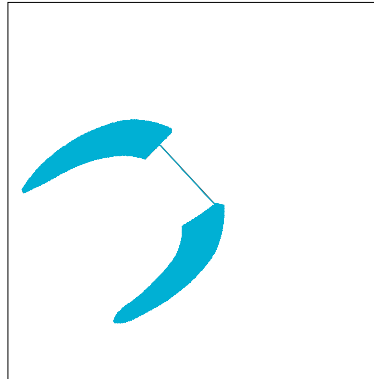

Stop #: 1
Element:
Code: 1243
Name: Pea Coat
Chart: Madeira Classic 40
Stitches: 7,053
Thread used: 43.56m

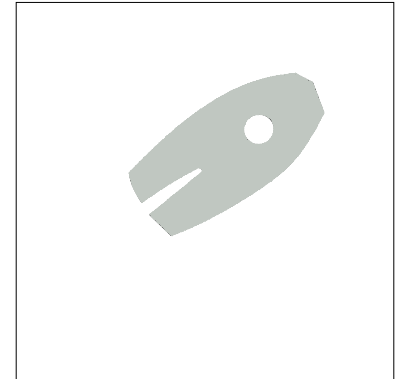

Stop #: 2
Element:
Code: 1095
Name: Larimar
Chart: Madeira Classic 40
Stitches: 2,803
Thread used: 15.63m



Stop #: 3
Element:
Code: 1010
Name: Gray Haze
Chart: Madeira Classic 40
Stitches: 4,207
Thread used: 27.12m

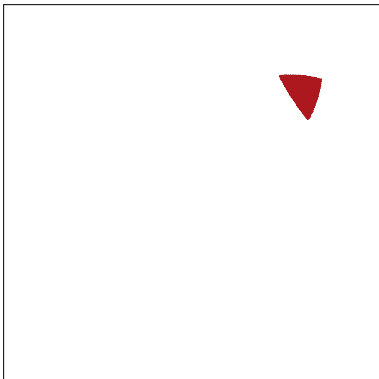

Stop #: 4
Element:
Code: 1147
Name: Christmas Red
Chart: Madeira Classic 40
Stitches: 376
Thread used: 2.02m

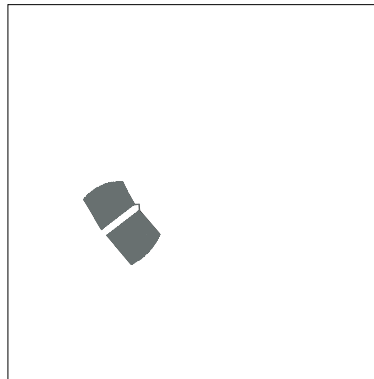

Stop #: 5
Element:
Code: 1415
Name:
Chart: Madeira Classic 40
Stitches: 905
Thread used: 5.38m

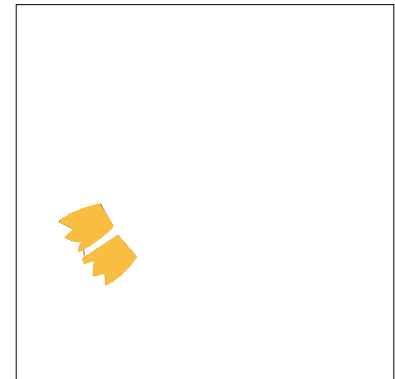

Stop #: 6
Element:
Code: 1171
Name: Lemon Drop
Chart: Madeira Classic 40
Stitches: 969
Thread used: 5.26m

Color Film

Wilcom EmbroideryStudio - Designing

ROKAT 5X5

Design: **Rokat 5x5**

Title:

Stitches: 25,044
Height: 93.9 mm
Width: 127.2 mm
Colors: 9
Colorway: Colorway 1
Zoom: 0.37

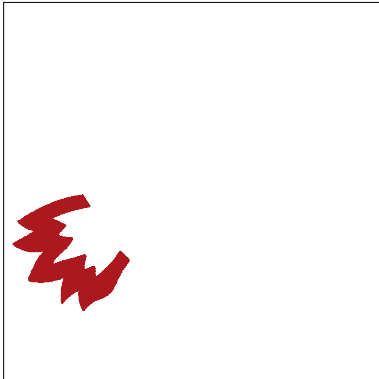

support@zdigitizing.com
+1 (213) 788-6748

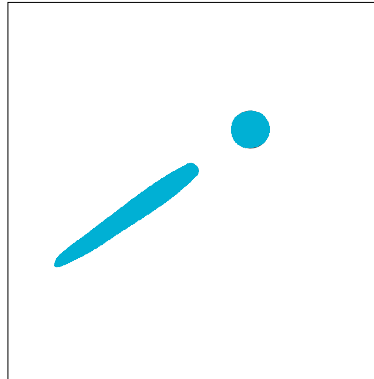

Stop #: 7
Element:
Code: 1147
Name: Christmas Red
Chart: Madeira Classic 40
Stitches: 1,845
Thread used: 9.89m

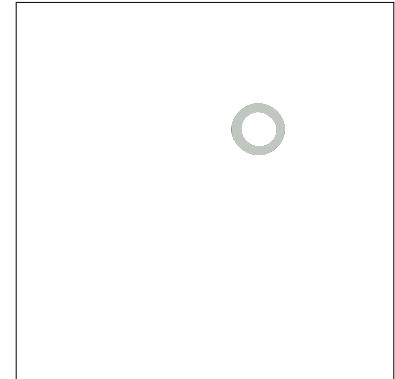

Stop #: 8
Element:
Code: 1095
Name: Larimar
Chart: Madeira Classic 40
Stitches: 1,487
Thread used: 7.94m



Stop #: 9
Element:
Code: 1010
Name: Gray Haze
Chart: Madeira Classic 40
Stitches: 370
Thread used: 2.24m

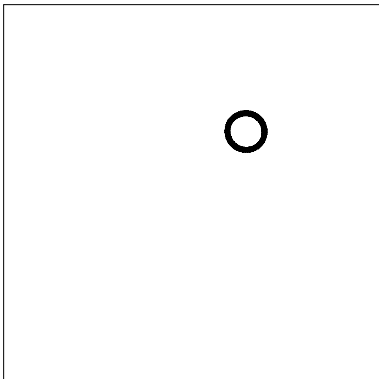

Stop #: 10
Element:
Code: 1000
Name: Black
Chart: Madeira Classic 40
Stitches: 299
Thread used: 1.38m

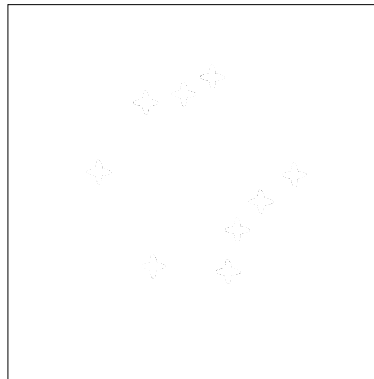

Stop #: 11
Element:
Code: 1001
Name: White
Chart: Madeira Classic 40
Stitches: 1,156
Thread used: 5.04m

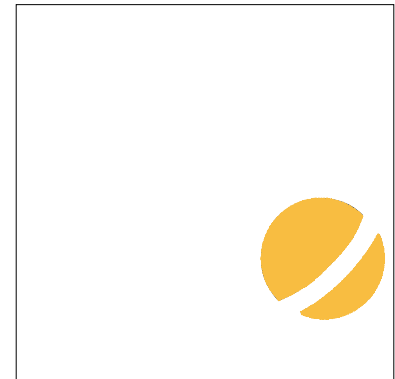

Stop #: 12
Element:
Code: 1171
Name: Lemon Drop
Chart: Madeira Classic 40
Stitches: 2,754
Thread used: 16.79m

Color Film

Wilcom EmbroideryStudio - Designing

ROKAT 5X5

Design: **Rokat 5x5**

Title:

Stitches: 25,044
Height: 93.9 mm
Width: 127.2 mm
Colors: 9
Colorway: Colorway 1
Zoom: 0.37

z digitizing
support@zdigitizing.com
+1 (213) 788-6748

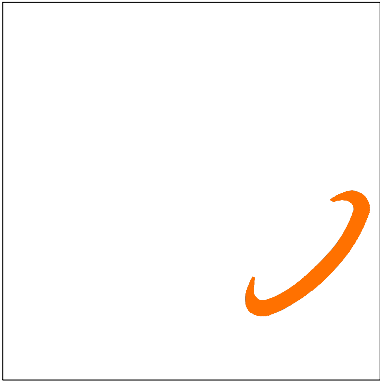

Stop #: 13
Element:
Code: 1278
Name: Orange Peel
Chart: Madeira Classic 40
Stitches: 818
Thread used: 6.55m